

浙江正泰电器股份有限公司

ZHEJIANG CHINT ELECTRICS CO.,LTD.

CB-63CXZ 塑料外壳式断路器产品规格书

Specification of CB-63CXZ Moulded-Case Circuit-Breaker



| | |
|---------------------|--|
| 产品名称/ Product name | 塑料外壳式断路器/ Moulded-Case Circuit-Breaker |
| 产品型号/ Product model | CB-63CXZ |
| 日期/ Date | 2023.08.07 |
| 版本/ Version | V1.0 |

| 拟制/ Prepared by | 校对/ Proofread by | 会签/ Countersigned by | 审定/ Reviewed by |
|--------------------|---------------------|--------------------------|--------------------|
| 陈一新 20230811 | 朱俊 20230811 | 李罗斌 20230817 冯洋 20230811 | 司莺歌 20230817 |

版本修订记录/ Revision record

| 版本/ Version | 需求项目/ Specification Requirement | 变更前规格要 求/Original Specifications | 变更后规格要求 /New Specifications | 变更原因/ Change Reason | 变更人/ Requested by | 变更日期/ Change Date |
|----------------|---------------------------------------|--|-----------------------------------|------------------------|-------------------------|-------------------------|
| V1.0 | | / | / | 首次发布/ First Release | 陈一新/ Yixin Chen | 2023.08.07 |
| | | | | | | |
| | | | | | | |

CB-63CXZ 塑料外壳式断路器产品规格书

Specification of CB-63CXZ Moulded-Case Circuit-Breaker

1 产品名称/ Name

塑料外壳式断路器/ Moulded-case circuit-breaker

2 规格型号/ Model

| | | | | | | | |
|----------|----------|---|-----------|-----------|----------|--------------------------|--------------------------|
| <u>C</u> | <u>B</u> | - | <u>63</u> | <u>CX</u> | <u>Z</u> | <input type="checkbox"/> | <input type="checkbox"/> |
| 1 | 2 | | 3 | 4 | 5 | 6 | 7 |

| 序号/ Serial number | 标识/ Logo | 含义/ Meaning |
|-------------------------|------------------------------------|--|
| 1 | C | 专用于通信市场/ Special for communications market |
| 2 | B | 断路器/ Circuit-Breaker |
| 3 | 63 | 壳架等级电流/ Frame size rated current |
| 4 | CX | 插入式/ Plug-in |
| 5 | Z | 直流/ Direct-current |
| 6 | 1P | 极数/ Poles: 1P |
| 7 | 6A,10A,16A,20A,25A,32A,40A,50A,63A | 额定电流/ Rated current: 6A,10A,16A,20A,25A,32A,40A,50A,63A |

3 执行标准/ Standards: GB/T 14048.2,IEC 60947-2

4 证书类型/ Certificate Type: CCC、TUV、CE

5 技术参数/ Technical Parameters

5.1 电气特性/ Electrical characteristics

- a) 额定工作电压/ Rated operational voltage U_e :DC80V
- b) 额定电流/ Rated current I_n :6A,10A,16A,20A,25A,32A,40A,50A,63A
- c) 额定运行短路分断电流/ Rated service short-circuit breaking capacity I_{cs} :10kA
- d) 额定极限短路分断能力/ Rated ultimate short-circuit breaking capacity I_{cu} :10kA
- e) 额定瞬时短路电流整定值/ Rated instantaneous short-circuit current setting: $I_i = 11I_n$

地址: 浙江省乐清市北白象镇正泰工业园区正泰路1号

邮编/Post: 325603

电话/Tel: (0577) 62877777

Add: No.1, CHINT Road, CHINT Industrial Zone, North Baixiang, Yueqing, Zhejiang Province.

- f) 工频耐压/ Power-frequency withstand voltage:2500V
- g) 额定冲击耐受电压/ Rated impulse withstand voltage U_{imp} :6kV

5.2 机械电气寿命/ Mechanical and electrical endurance

- a) 机械寿命/ Mechanical endurance:10000 次/ times
- b) 电气寿命/ Electrical endurance:4000 次/ times

5.3 脱扣曲线/ Tripping curve

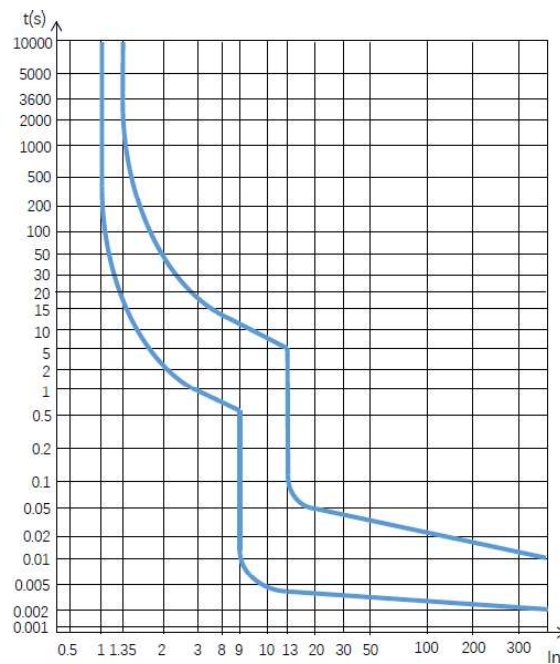

6 工作环境/ Working environment

- a) 海拔/ Altitude: $\leq 2000\text{m}$
- b) 环境温度/ Ambient temperature: $-40^{\circ}\text{C} \sim +70^{\circ}\text{C}$
- c) 空气相对湿度/ Relative air humidity: $\leq 95\%$
- d) 污染等级/ Pollution level:3 级/ Level 3
- e) 无显著振动和冲击的地方/ Place without significant vibration and impact

7 外形尺寸/ Overall dimensions

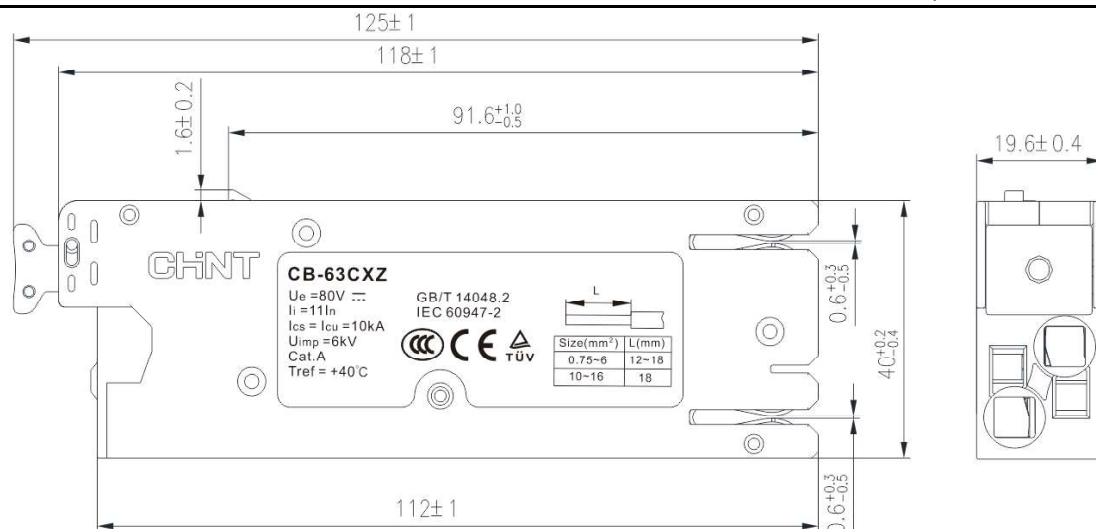

8 产品简介/ Product introduction

8.1 基本情况/ Basic information

- 具有过载及短路保护装置—保护功能齐全/ Equipped with overload and short-circuit protection devices – complete protection functions
- 插入式安装方式—安装简捷方便/ Plug-in mounting — Convenient and easy installation
- 符合 RoHS 要求/ Comply with RoHS requirements
- 运输保管/ Transportation and storage
 - 在运输、保管过程中，均不得受雨水侵袭/ The product shall be kept away from rain during transportation and storage
 - 产品应贮存在无雨雪侵入、空气流通、空气温度不高于+85℃与不低于-40℃、周围空气中无酸性、碱性或其它腐蚀性气体的环境中储存/ The Product should be stored in an environment protected from rain and snow, in ventilation, air temperature of no more than +85℃ and no less than -40℃, and without acid, alkaline or other corrosive gases in the surrounding air

8.2 接线能力/ Wiring capacity: (0.75~16) mm² 铜导线/ Copper conductor

8.3 安装及拆卸说明/ Installation and removal instructions:

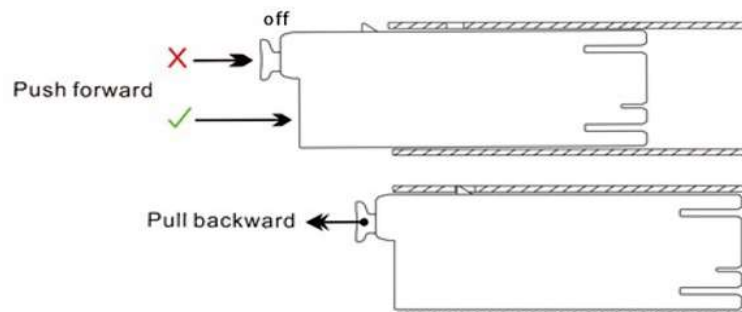

注/ Remark: 产品内外包装物按实际接收的为准/ The inner and outer packaging of the product shall be subject to the actual received..