

浙江正泰电器股份有限公司

ZHEJIANG CHINT ELECTRICS CO.,LTD.

CB-125CX 4P 125A 塑料外壳式断路器产品规格书

Specification of CB-125CX 4P 125A Moulded-Case Circuit-Breaker



产品名称/ Product name	塑料外壳式断路器/ Moulded-Case Circuit-Breaker
产品型号/ Product model	CB-125CX
日期/ Date	2023.10.23
版本/ Version	V1.0

拟制/ Prepared by	校对/ Proofread by	会签/ Countersigned by	审定/ Reviewed by
刘瑾 20231024	朱俊 20231025	冯洋 20231028 李罗斌 20231025	司莺歌 20231030

版本修订记录/ Revision record

版本/ Version	需求项目/ Specification Requirement	变更前规格要 求/Original Specifications	变更后规格要求 /New Specifications	变更原因/ Change Reason	变更人/ Requested by	变更日期/ Change Date
V1.0	维谛	/	/	首次发布/ First Release	刘瑾/Jin Liu	2023.10.23

CB-125CX 4P 125A 塑料外壳式断路器产品规格书

Specification of CB-125CX 4P 125A Moulded-Case Circuit-Breaker

1 产品名称/ Name

塑料外壳式断路器/ Moulded-case circuit-breaker

2 规格型号/ Model

<u>C</u>	<u>B</u>	-	<u>125</u>	<u>CX</u>	<u>4P</u>	<u>125A</u>
1	2		3	4	5	6

序号/ Serial number	标识/ Logo	含义/ Meaning
1	C	专用于通信市场/ Special for communications market
2	B	断路器/Circuit breaker
3	125	壳架等级/ Frame size rated current
4	CX	插入式/ Plug-in
5	4P	极数/Poles: 4P
6	125A	断路器额定电流/Rated current: 125A

3 执行标准/ Standards: GB/T 14048.2, IEC 60947-2

4 证书类型/ Certificate Type: CCC, TUV, CE

5 技术参数/ Technical Parameters

5.1 电气特性/ Electrical characteristics

- a) 额定工作电压/ Rated operational voltage U_c : AC400V/415V
- b) 额定电流/ Rated current I_n : 125A
- c) 额定运行短路分断能力/ Rated service short-circuit breaking capacity I_{cs} : 6kA
- d) 额定极限短路分断能力/ Rated ultimate short-circuit breaking capacity I_{cu} : 6kA
- e) 额定瞬时短路电流整定值/ Rated instantaneous short-circuit current setting: $I_i = 8I_n$
- f) 工频耐压/ Power-frequency withstand voltage: 2500V
- g) 额定冲击耐受电压/ Rated impulse withstand voltage U_{imp} : 4kV

5.2 机械电气寿命/ Mechanical and electrical endurance

- a) 机械寿命/ Mechanical endurance: 6000 次/ times
- b) 电气寿命/ Electrical endurance: 4000 次/ times

5.3 脱扣曲线/ Tripping curve

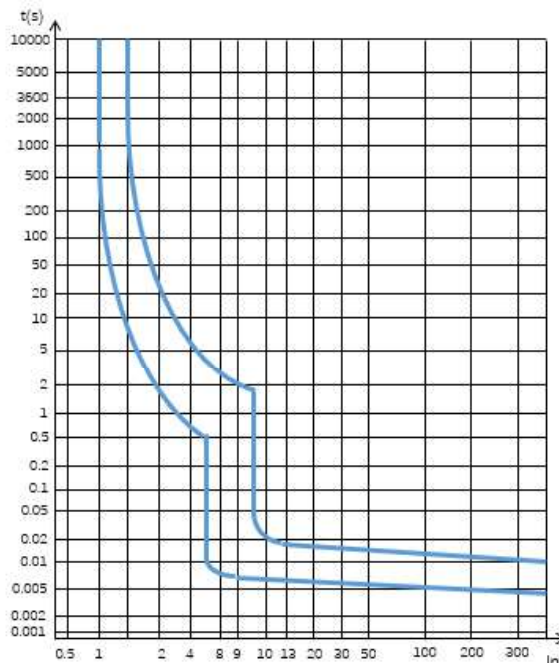

5.4 不同环境温度下使用电流修正值/ Current correction value used at different ambient temperature

额定电流 I_n / Rated current (A)	不同温度环境下使用电流修正值/Current correction value under different ambient temperature											
	-40℃	-30℃	-20℃	-10℃	0℃	10℃	20℃	30℃	40℃	50℃	60℃	70℃
125	1.36	1.32	1.28	1.24	1.2	1.16	1.12	1.06	1	0.95	0.95	0.90

6 工作环境/ Working environment

- a) 海拔/ Altitude: $\leq 2000\text{m}$
- b) 环境温度/ Ambient temperature: $-40^\circ\text{C} \sim +70^\circ\text{C}$
- c) 空气相对湿度/ Relative air humidity: $\leq 95\%$
- d) 污染等级/ Pollution level: 3 级/ Level 3
- e) 无显著振动和冲击的地方/ Place without significant vibration and impact

7 外形尺寸/ Overall dimensions

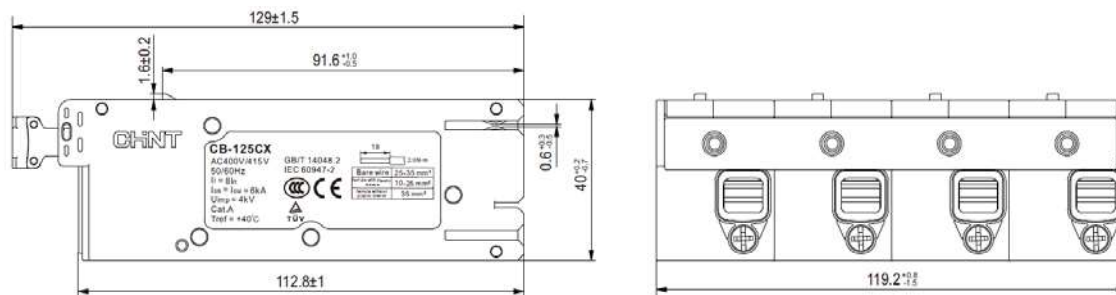

8 产品简介/ Product introduction

8.1 基本情况/ Basic information

- a) 具有过载及短路保护装置—保护功能齐全/ Equipped with overload and short-circuit protection devices – complete protection functions
- b) 插入式安装方式—安装简捷方便/ Plug-in mounting — Convenient and easy installation
- c) 符合 RoHS 要求/ Comply with RoHS requirements
- d) 运输保管/ Transportation and storage
 - 1) 在运输、保管过程中，均不得受雨水侵袭/ The product shall be kept away from rain during transportation and storage
 - 2) 产品应贮存在无雨雪侵入、空气流通、空气温度不高于+85℃与不低于-40℃、周围空气中无酸性、碱性或其它腐蚀性气体的环境中/ The Product should be stored in an environment protected from rain and snow, in ventilation, air temperature of no more than +85℃ and no less than -40℃, and without acid, alkaline or other corrosive gases in the surrounding air

8.2 接线能力/ Wiring capacity: (10~35)mm² 铜导线/ Copper conductor ,扭矩/ Torque 2.0Nm.

8.3 插拔力/ Insertion and Extraction Force

- a) 单极插入机框力/ Unipolar Insertion frame force: ≤40N
- b) 单极拔出机框力/ Unipolar Pull out frame force: ≤35N

尾部功率接口适配 2mm 连接排/ The tail power interface is adapted to 2mm thick busbar.

8.4 安装、拆卸说明/ Installation and disassembly instructions

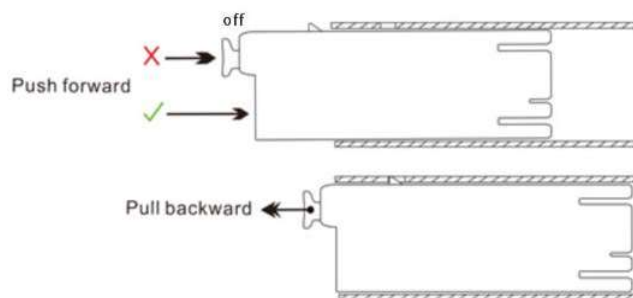

注/ Remark: 产品内外包装物按实际接收的为准/ The inner and outer packaging of the product shall be subject to the actual received.

地址: 浙江省乐清市北白象镇正泰工业园区正泰路 1 号

邮编/Post: 325603

电话/Tel: (0577) 62877777

Add: No.1, CHINT Road, CHINT Industrial Zone, North Baixiang, Yueqing, Zhejiang Province.